

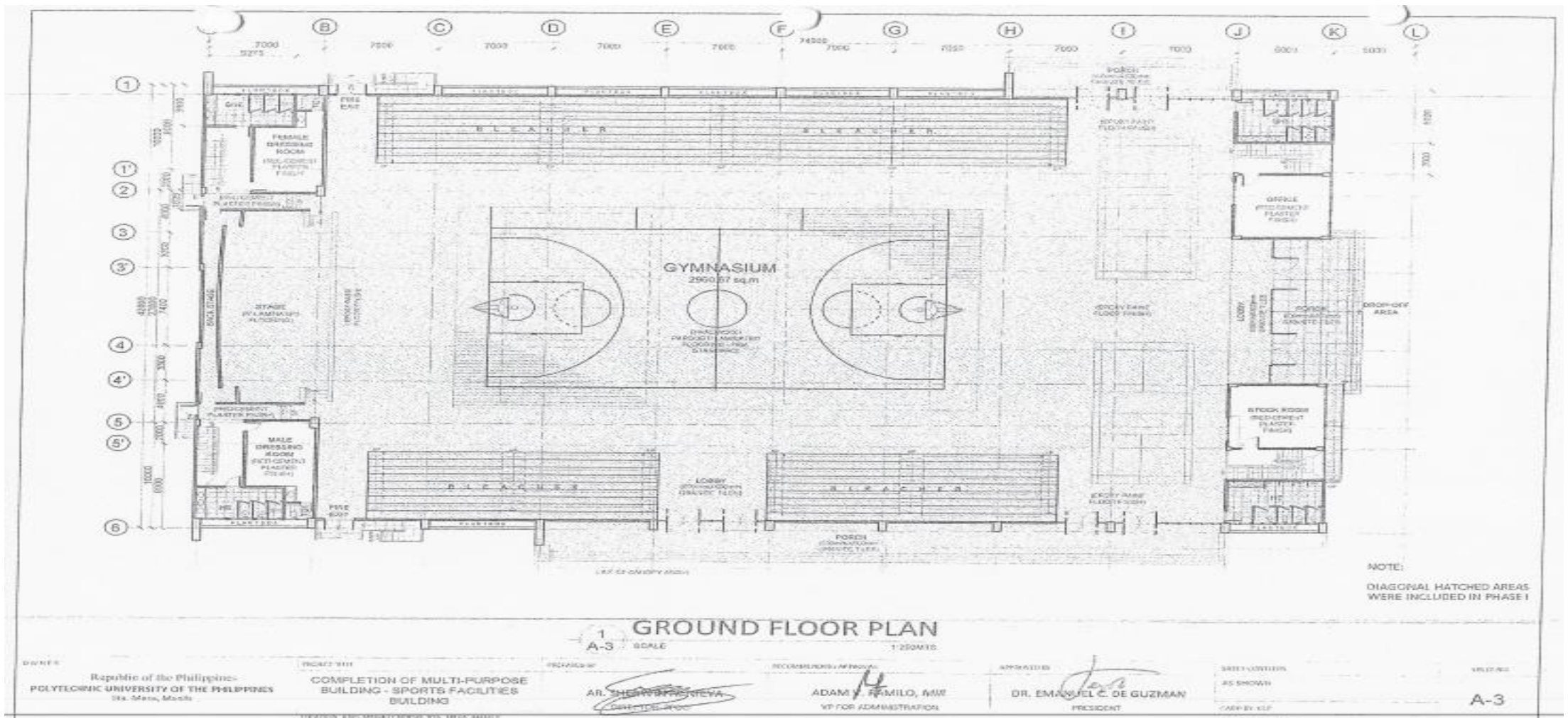

**POLYTECHNIC UNIVERSITY OF THE PHILIPPINES  
COLLEGE OF ENGINEERING  
COMPUTER ENGINEERING DEPARTMENT**



(02) 8713 5968 | dcoe\_chair@gmail.com  
RM322 CEA BLDG. NDC COMPOUND,  
ANONAS COR. PUREZA STREETS, STA. MESA, MANILA





**POLYTECHNIC UNIVERSITY OF THE PHILIPPINES  
COLLEGE OF ENGINEERING  
COMPUTER ENGINEERING DEPARTMENT**

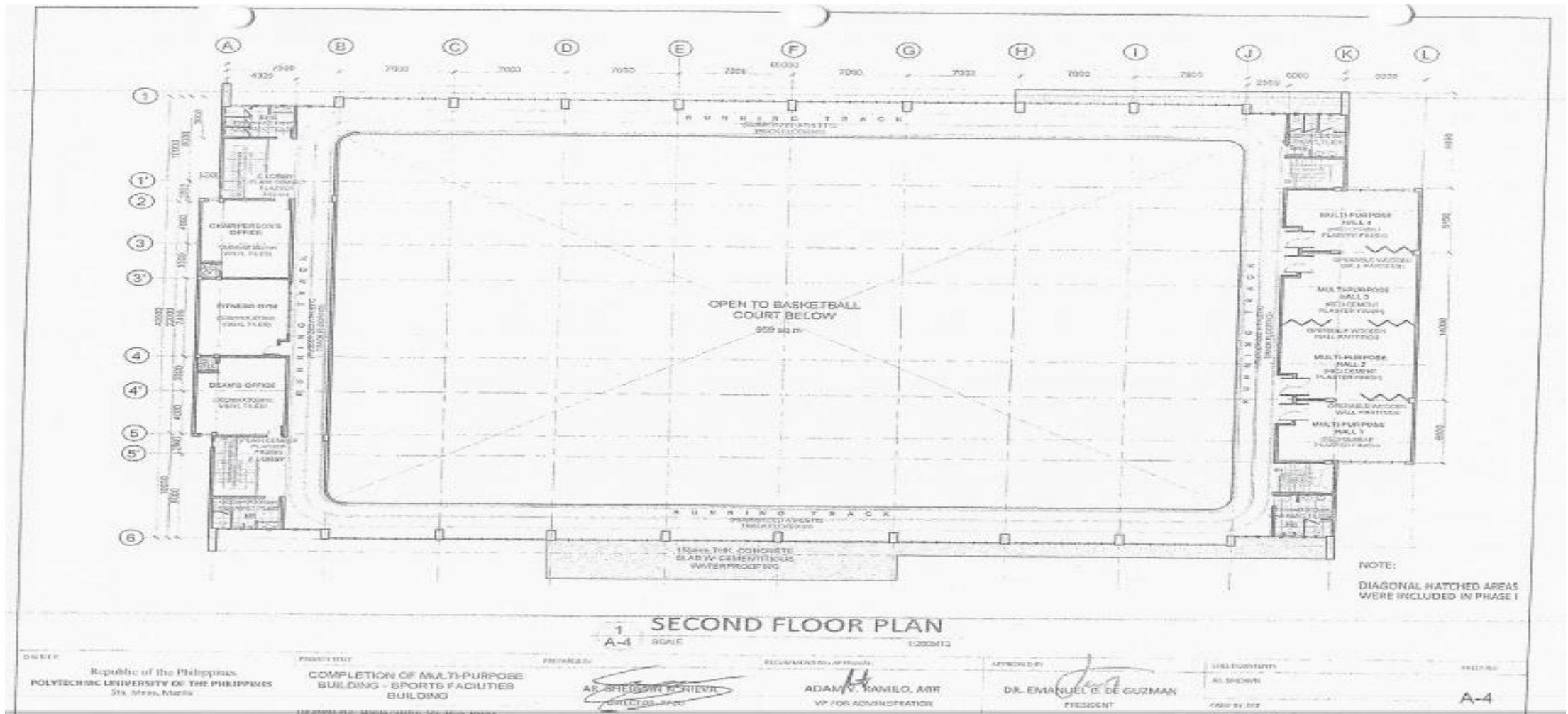

(02) 8713 5968 | [dcoe\\_chair@gmail.com](mailto:dcoe_chair@gmail.com)  
 RM322 CEA BLDG. NDC COMPOUND,  
 ANONAS COR. PUREZA STREETS, STA. MESA, MANILA







**POLYTECHNIC UNIVERSITY OF THE PHILIPPINES  
COLLEGE OF ENGINEERING  
COMPUTER ENGINEERING DEPARTMENT**

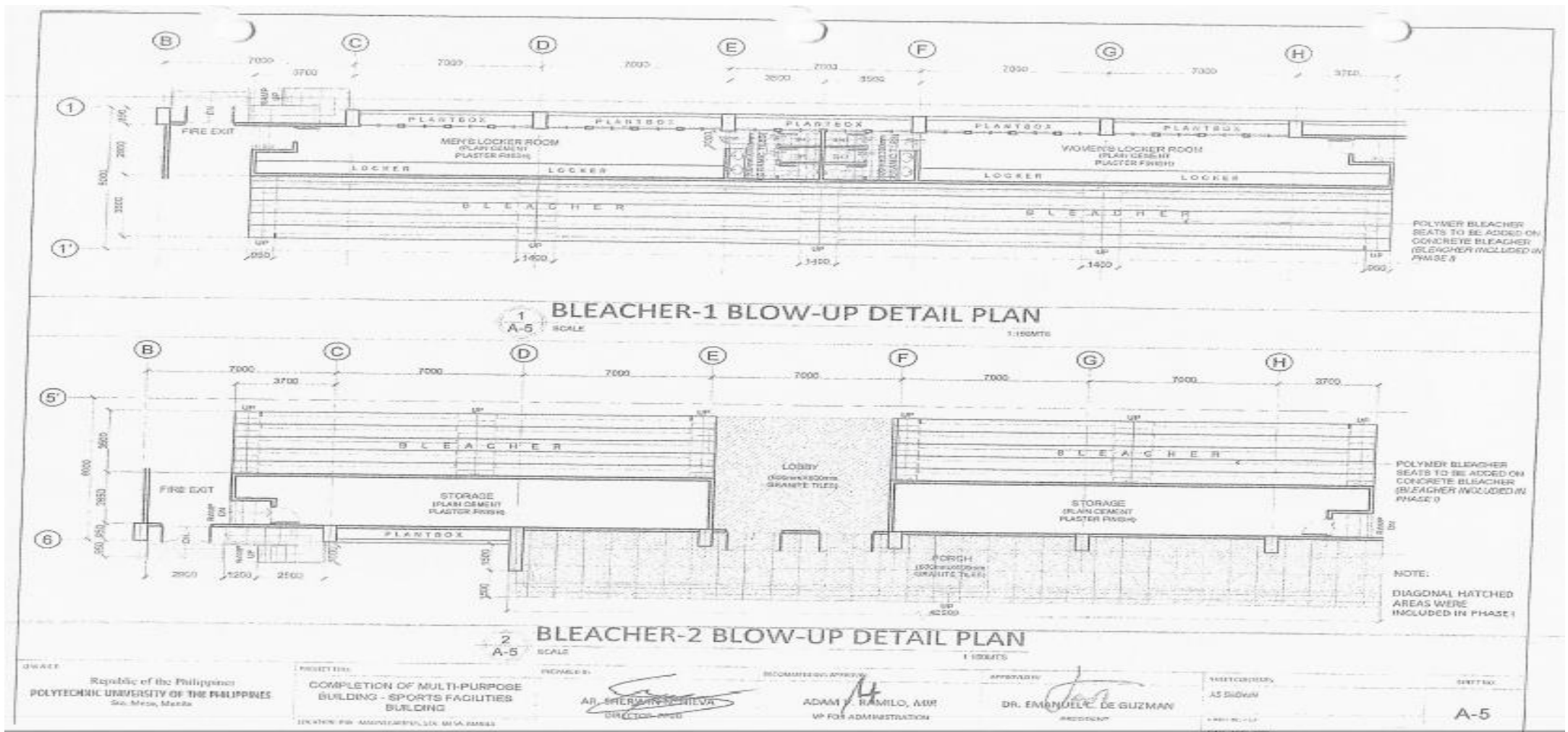

(02) 8713 5968 | dcoe\_chair@gmail.com  
RM322 CEA BLDG. NDC COMPOUND,  
ANONAS COR. PUREZA STREETS, STA. MESA, MANILA





POLYTECHNIC UNIVERSITY OF THE PHILIPPINES  
 COLLEGE OF ENGINEERING  
**COMPUTER ENGINEERING DEPARTMENT**

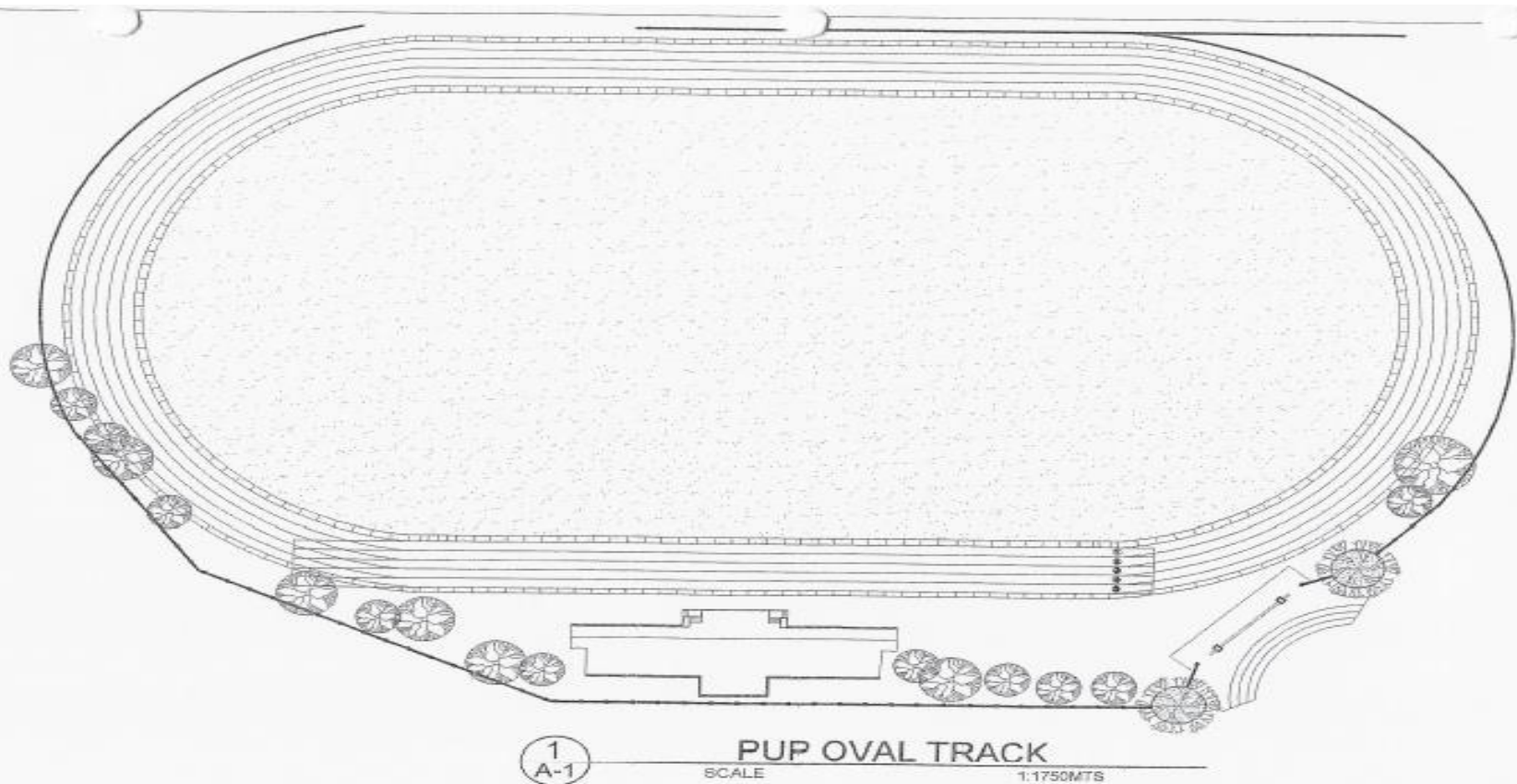

OWNER Republic of the Philippines POLYTECHNIC UNIVERSITY OF THE PHILIPPINES Sta. Mesa, Manila	PROJECT TITLE PUP OVAL TRACK PLAN LOCATION: PUP-VARDIN CAMPUS, STA. MESA, MANILA	PREPARED BY AR./ENR. <i>SHERWIN N. BIEVA</i> DIRECTOR PHYSICAL PLANNING AND DEVELOPMENT SERVICE	SHEET CONTENTS AS SHOWN DATED BY: ADP DATE: SEPTEMBER 2018	SHEET NO. A-1
--	--	---	---	------------------

(02) 8713 5968 | [dcoe\\_chair@gmail.com](mailto:dcoe_chair@gmail.com)  
 RM322 CEA BLDG. NDC COMPOUND,  
 ANONAS COR. PUREZA STREETS, STA. MESA, MANILA





POLYTECHNIC UNIVERSITY OF THE PHILIPPINES  
 COLLEGE OF ENGINEERING  
**COMPUTER ENGINEERING DEPARTMENT**

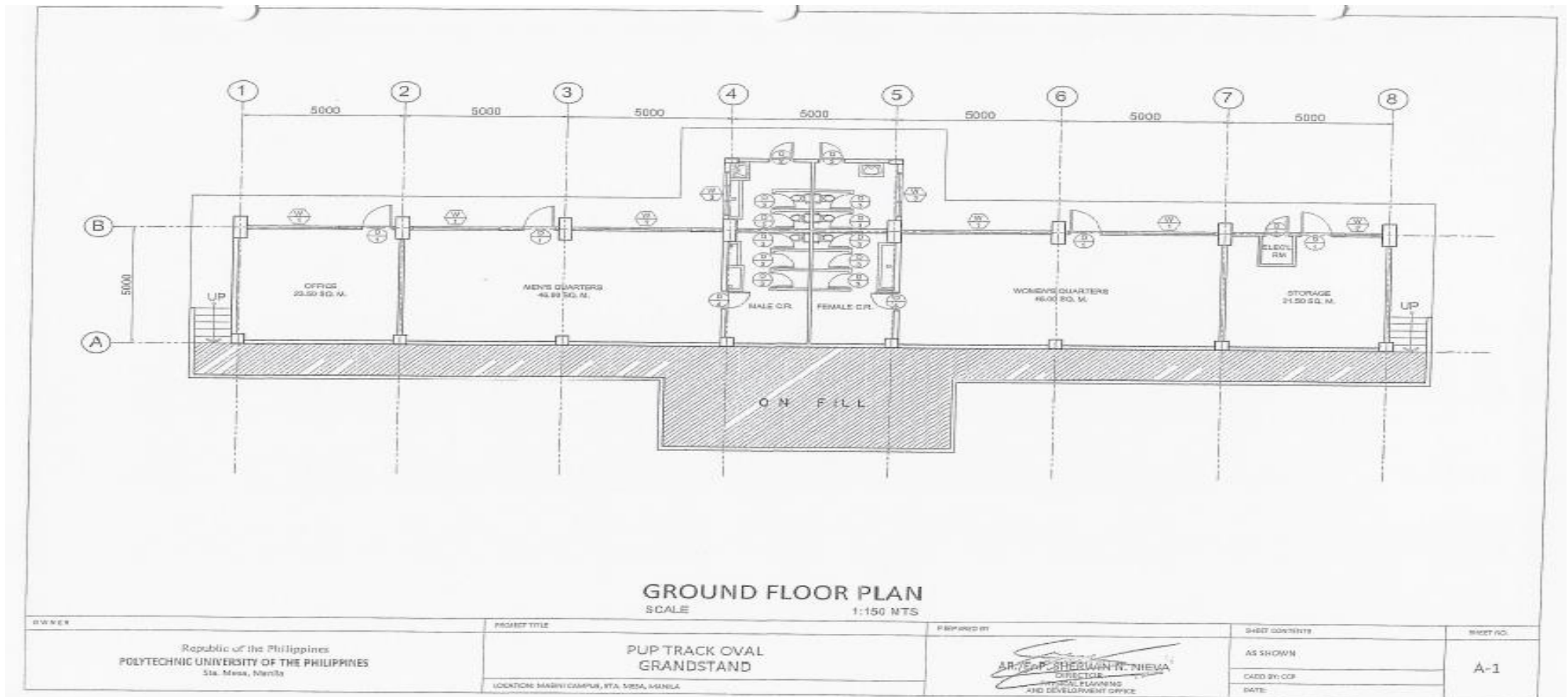

(02) 8713 5968 | [dcoe\\_chair@gmail.com](mailto:dcoe_chair@gmail.com)  
 RM322 CEA BLDG. NDC COMPOUND,  
 ANONAS COR. PUREZA STREETS, STA. MESA, MANILA







**POLYTECHNIC UNIVERSITY OF THE PHILIPPINES  
COLLEGE OF ENGINEERING  
COMPUTER ENGINEERING DEPARTMENT**

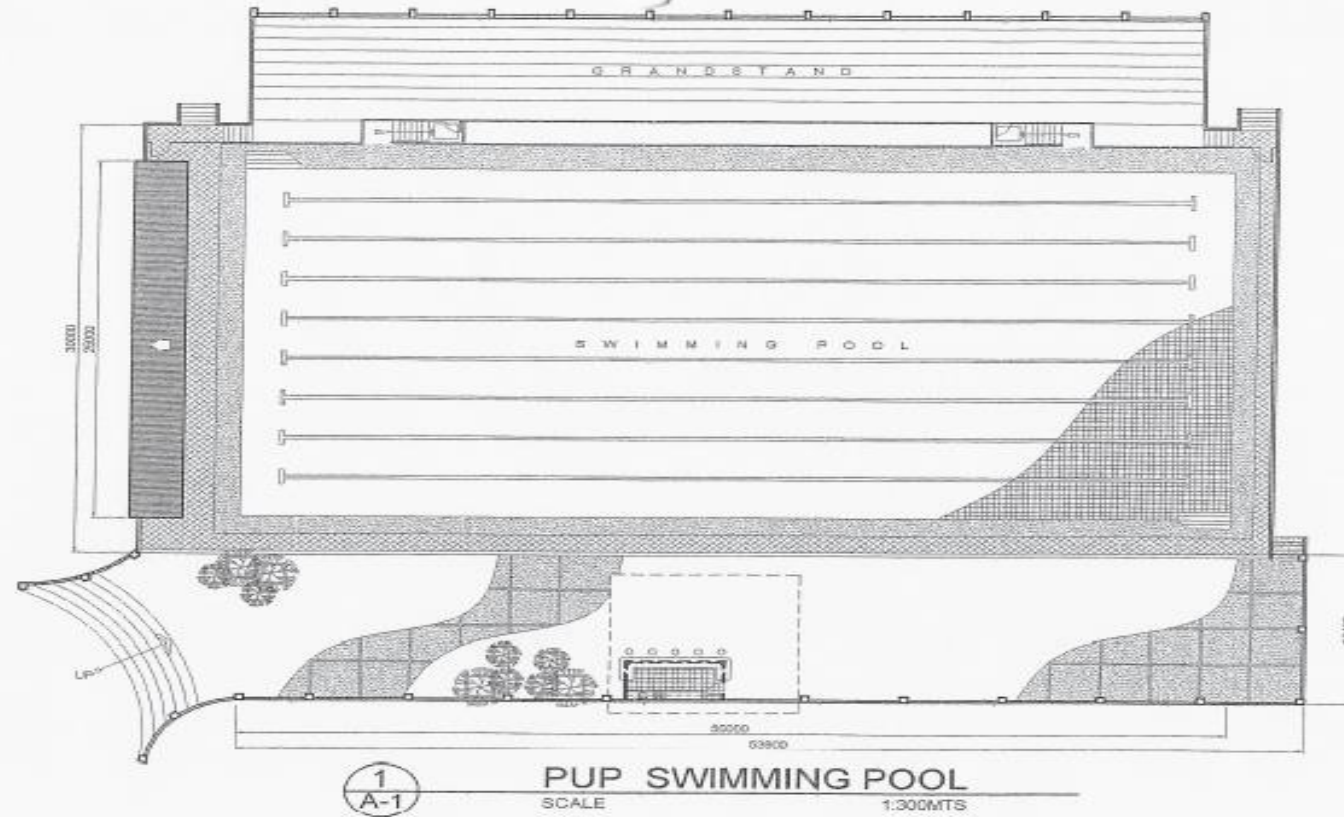

**1**  
**A-1** PUP SWIMMING POOL  
SCALE 1:300MTS

OWNER	PROJECT TITLE	PREPARED BY	SHEET CONTENTS	SHEET NO.
Republic of the Philippines POLYTECHNIC UNIVERSITY OF THE PHILIPPINES 319, MESS, MARCOS	PUP SWIMMING POOL <small>LOCATION: PUP-MORIN CAMPUS, STA. MESA, MANILA</small>	<i>[Signature]</i> DR. JENIF. SHERWIN N. STEVA PHYSICAL PLANNING AND DEVELOPMENT OFFICE	AS SHOWN CADD BY: AUP DATE: SEPTEMBER 2016	A-1

(02) 8713 5968 | [dcoe\\_chair@gmail.com](mailto:dcoe_chair@gmail.com)  
RM322 CEA BLDG. NDC COMPOUND,  
ANONAS COR. PUREZA STREETS, STA. MESA, MANILA



**ISO 9001:2015 CERTIFIED**  
CERTIFICATE NUMBER: SCP0004130



POLYTECHNIC UNIVERSITY OF THE PHILIPPINES  
 COLLEGE OF ENGINEERING  
**COMPUTER ENGINEERING DEPARTMENT**

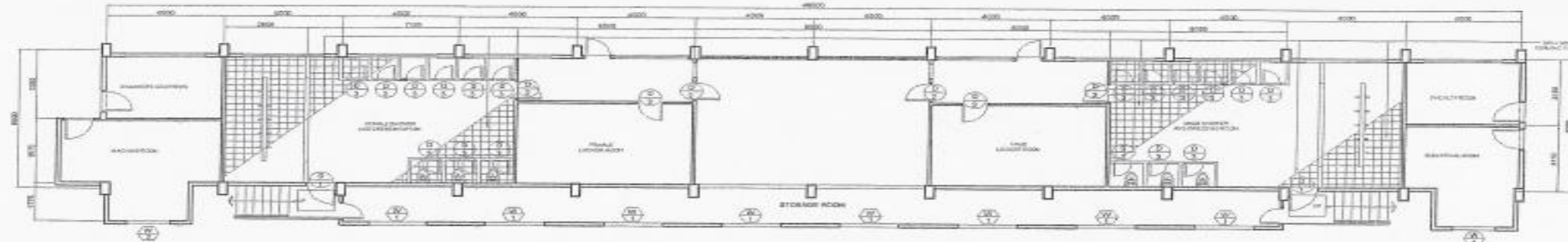

**1**  
A-1  
GRANDSTAND GROUND FLOOR PLAN  
SCALE 1:300MTS

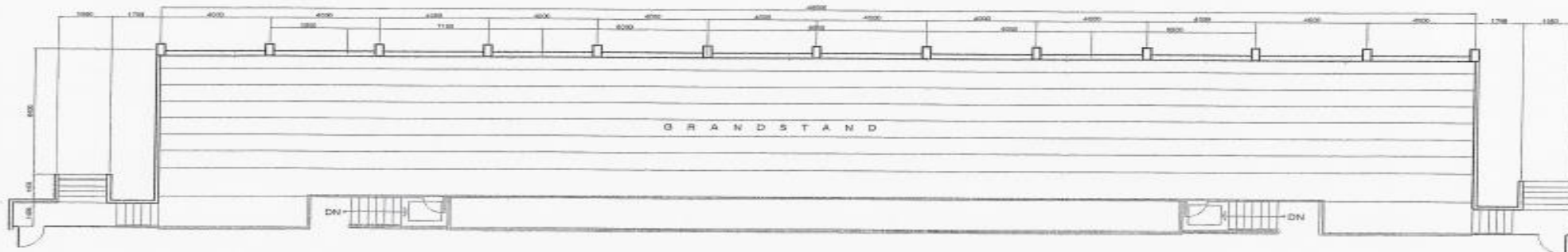

**2**  
A-2  
GRANDSTAND SECOND FLOOR PLAN  
SCALE 1:300MTS

OWNER	PROJECT TITLE	PREPARED BY	SHEET CONTENTS	SHEET NO.
Republic of the Philippines POLYTECHNIC UNIVERSITY OF THE PHILIPPINES Sta. Mesa, Manila	PUP SWIMMING POOL GRANDSTAND <small>LOCATION: PUP-MANILA CAMPUS, 1735 MPPA, MANILA</small>	AR/ENR. SHERWIN ISNENA DIRECTOR PHYSICAL PLANNING AND DEVELOPMENT OFFICE	AS SHOWN CADD BY: ACP DATE: 2016/05/23	A-2

(02) 8713 5968 | [dcoe\\_chair@gmail.com](mailto:dcoe_chair@gmail.com)  
 RM322 CEA BLDG. NDC COMPOUND,  
 ANONAS COR. PUREZA STREETS, STA. MESA, MANILA



ISO 9001:2015 CERTIFIED  
 CERTIFICATE NUMBER: SCP0004130



**POLYTECHNIC UNIVERSITY OF THE PHILIPPINES  
COLLEGE OF ENGINEERING  
COMPUTER ENGINEERING DEPARTMENT**



(02) 8713 5968 | dcoe\_chair@gmail.com  
 RM322 CEA BLDG. NDC COMPOUND,  
 ANONAS COR. PUREZA STREETS, STA. MESA, MANILA







**POLYTECHNIC UNIVERSITY OF THE PHILIPPINES  
COLLEGE OF ENGINEERING  
COMPUTER ENGINEERING DEPARTMENT**

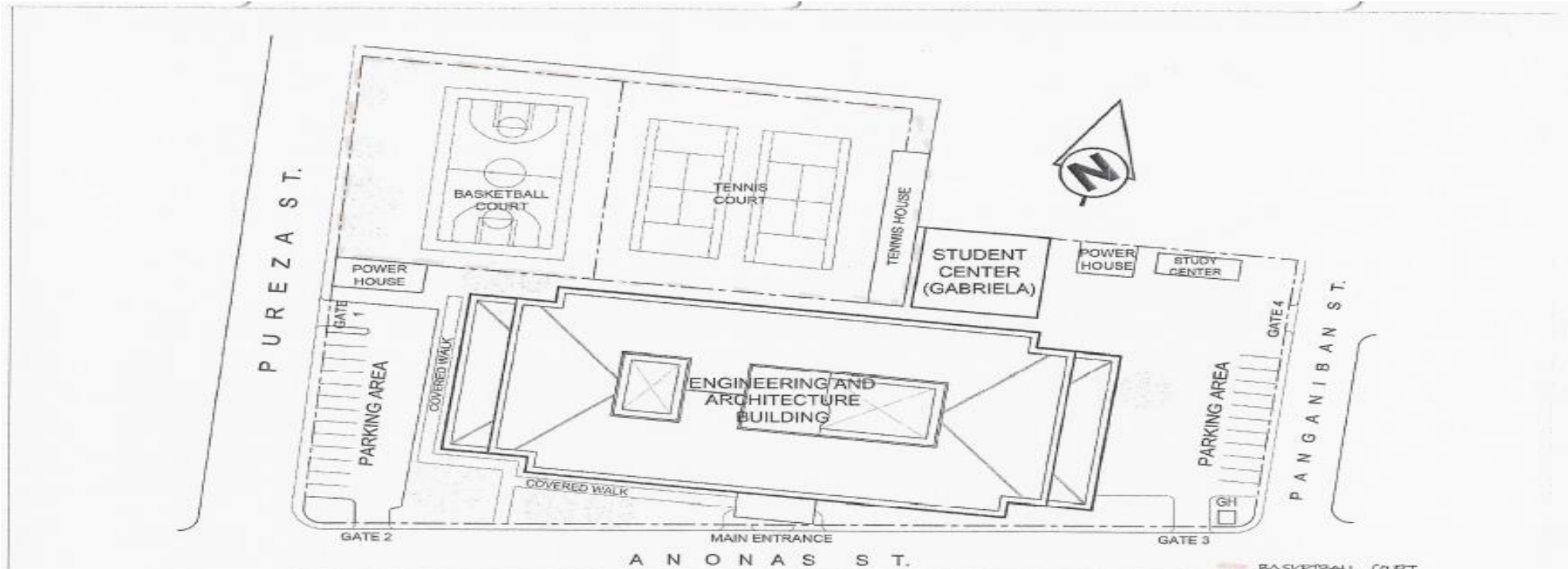

**S I T E   D E V E L O P M E N T   P L A N**  
SCALE 1:700MTS

OWNER	PROJECT TITLE	PREPARED BY	SHEET CONTENTS	SHEET NO.
Republic of the Philippines POLYTECHNIC UNIVERSITY OF THE PHILIPPINES Sta. Mesa, Manila	COLLEGE OF ENGINEERING AND ARCHITECTURE SITE DEVELOPMENT PLAN <small>LOCATION: NDC CAMPUS, STA. MESA, MANILA</small>	AR. JEROME SHERWIN N. NIEVA DIRECTOR PHYSICAL PLANNING AND DEVELOPMENT OFFICE	AS SHOWN GATE BY ALDI GATE	A-1

(02) 8713 5968 | dcoe\_chair@gmail.com  
RM322 CEA BLDG. NDC COMPOUND,  
ANONAS COR. PUREZA STREETS, STA. MESA, MANILA





**POLYTECHNIC UNIVERSITY OF THE PHILIPPINES  
COLLEGE OF ENGINEERING  
COMPUTER ENGINEERING DEPARTMENT**



- |                                       |   |   |  |  |   |
|---------------------------------------|---|---|--|--|---|
| 1. PYLON                              | 9. TRACK AND FOOTBALL DOWL                    | 17. TENNIS COURT                                    | 25. MIMO AQUINO LEARNING AND RESOURCE CENTER | 33. INTERFAITH CHAPEL                                  | 41. CHARLIE DEL ROSARIO HALL (STUDENT CENTER) |
| 2. MURAL BRASS SCULPTURE              | 10. GRANDSTAND                                | 18. OUTDOOR BASKETBALL AND VOLLEYBALL COURT         | 26. LASCORN                                  | 34. COLLEGE OF NUTRITION & FOOD SCIENCE BUILDING       | 42. LABORATORY HIGH SCHOOL BUILDING           |
| 3. GUARD HOUSE                        | 11. GAZEBO                                    | 19. ENGINEERING AND SCIENCE RESEARCH CENTER         | 27. AMPHI THEATER                            | 35. CAMPUS DEVELOPMENT AND MAINTENANCE OFFICE BUILDING | 43. PRINTING PRESS BUILDING                   |
| 4. VISITOR INFORMATION CENTER         | 12. MABINI REPLICHA HOUSE                     | 20. MULTI-PURPOSE AND SPORTS DEVELOPMENT FACILITY   | 28. PUP MAM ACADEMIC BUILDING (NORTH WING)   | 36. PUP FERRY STATION                                  | 44. SUPPLIES AND PROPERTY MANAGEMENT OFFICE   |
| 5. COVERED WALK                       | 13. MABINI SHRINE MUSEUM & INFORMATION CENTER | 21. SWIMMING POOL                                   | 29. PUP MAM ACADEMIC BUILDING (EAST WING)    | 37. GENERATOR HOUSE                                    | 45. R.C. OVERHEAD WATER TANK                  |
| 6. TAHANAN NG ATLETA                  | 14. FLAG POLE                                 | 22. PUP TAHANAN NG ALAMIN                           | 30. PUP MAM ACADEMIC BUILDING (COMB)         | 38. LINEAR PARK  | 46. R.C. UNDERGROUND WATER TANK               |
| 7. COMMUNITY BUILDING GABRIELA SILANG | 15. FREEDOM PARK                              | 23. PHYSICAL EDUCATION BUILDING                     | 31. PUP MAM ACADEMIC BUILDING (WEST WING)    | 39. UNIVERSITY CANTEEN/SAMPAGUITA BUILDING             | 47. PUMP HOUSE                                |
| 8. BAHAY UGHWAN                       | 16. MABINI MONUMENT/PUP OBELISK               | 24. FOOD TECHNOLOGY RESEARCH AND DEVELOPMENT CENTER | 32. PUP MAM ACADEMIC BUILDING (SOUTH WING)   | 40. STUDENT CANTEN                                     |   |

OWNER Republic of the Philippines <b>POLYTECHNIC UNIVERSITY OF THE PHILIPPINES</b> Sta. Mesa, Manila	PROJECT TITLE <b>MASTER SITE DEVELOPMENT PLAN</b> (MABINI CAMPUS)	PREPARED BY <b>AR JEDP. SHERWIN N. MEVA</b> DIRECTOR CAPITAL PLANNING AND DEVELOPMENT CENTER	SHEET CONTENTS AS SHOWN DATED BY (DATE)	SHEET NO. <b>A-1</b>
---	---	---	--	-------------------------

(02) 8713 5968 | [dcoe\\_chair@gmail.com](mailto:dcoe_chair@gmail.com)  
 RM322 CEA BLDG. NDC COMPOUND,  
 ANONAS COR. PUREZA STREETS, STA. MESA, MANILA







POLYTECHNIC UNIVERSITY OF THE PHILIPPINES  
COLLEGE OF ENGINEERING  
**COMPUTER ENGINEERING DEPARTMENT**

Below exhibits the facilities that the Program holds activities related to athletic sport, cultural programs.



**PUP OVAL MAIN ENTRANCE  
AND PUP GRANDSTAND**





POLYTECHNIC UNIVERSITY OF THE PHILIPPINES  
COLLEGE OF ENGINEERING  
**COMPUTER ENGINEERING DEPARTMENT**



**BASEBALL AND FOOTBALL FIELD**





POLYTECHNIC UNIVERSITY OF THE PHILIPPINES  
COLLEGE OF ENGINEERING  
**COMPUTER ENGINEERING DEPARTMENT**

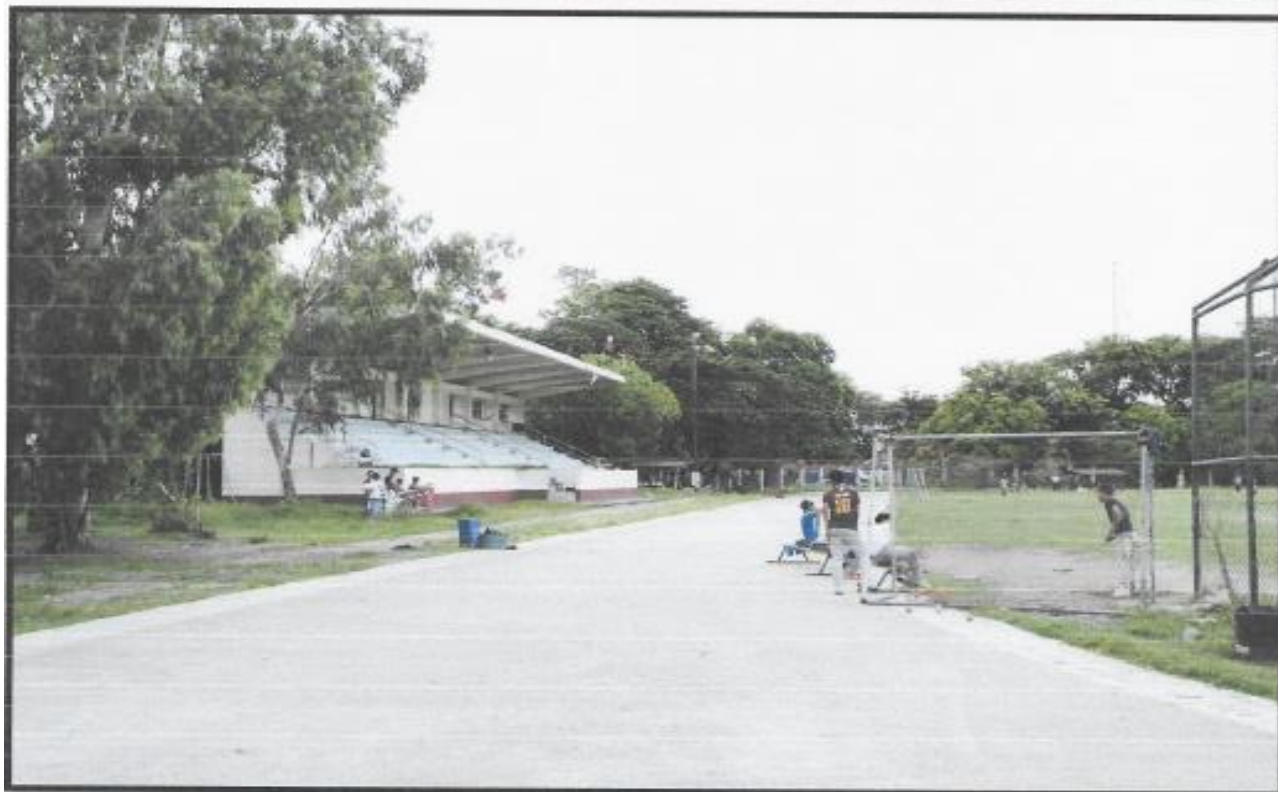

**PUP TRACK AND FIELD OVAL**



POLYTECHNIC UNIVERSITY OF THE PHILIPPINES  
COLLEGE OF ENGINEERING  
**COMPUTER ENGINEERING DEPARTMENT**

**D. TRACK OVAL**

• **Laboratory Manual**

**Rules and Regulation:**

1. Students should wear the proper uniform and rubber shoes in the Track oval.
2. Food and drinks are not allowed at the oval.
3. Only students with scheduled Physical education classes can enter the oval. Spectators/observers who wish to enter have to ask the permission of the Physical Education teacher/instructor in charge.
4. All equipment used during classes like starting blocks, hurdles, jumping and throwing should be supervise by coaches / trainers must be properly returned to the equipment area after using.
5. For varsity practices, the team can use the oval during scheduled practices.
6. Presence of the trainor/coach of the varsity team is a requirement during practices.
7. It is the coach's/trainor's/adviser's responsibility to observe the proper use of the area.
8. Maintain cleanliness at times.

**TRACK OVAL MANUAL**

**(Used to discuss all about the information about laboratory manual on the track oval)**





POLYTECHNIC UNIVERSITY OF THE PHILIPPINES  
COLLEGE OF ENGINEERING  
**COMPUTER ENGINEERING DEPARTMENT**

• Operation Manual

1. The Track oval is open 6:00 am – 12:00 pm and 1:00 pm – 6:00 pm, Monday – Saturday. However the training of our University Athletes will always be given top priority.
2. Activities requiring the use of the service facility for more than five (5) days (except sports) shall not be allowed.
3. The Track oval is exclusive for sports related activity and for big events.
4. Those who want to avail the use of the Track oval for tournaments and other events on exclusive or non-exclusive shall secure a Facility Reservation Form.
5. The request shall be endorsed by VPAA for activities sponsored by various colleges and faculty organizations; VPA for activity sponsored by various administrative offices and organizations and request from the outsiders; VPSS for activities sponsored by various student organization, academic or non-academic.
6. The Vice-President for Finance shall make the approval of request.
7. Track oval rates Php 2,000.00 per hour daytime 3,000.00 per hour at nighttime due to the use of lights.

## TRACK OVAL MANUAL

(Used to discuss all about the information about operation manual on the track oval)



POLYTECHNIC UNIVERSITY OF THE PHILIPPINES  
COLLEGE OF ENGINEERING  
**COMPUTER ENGINEERING DEPARTMENT**

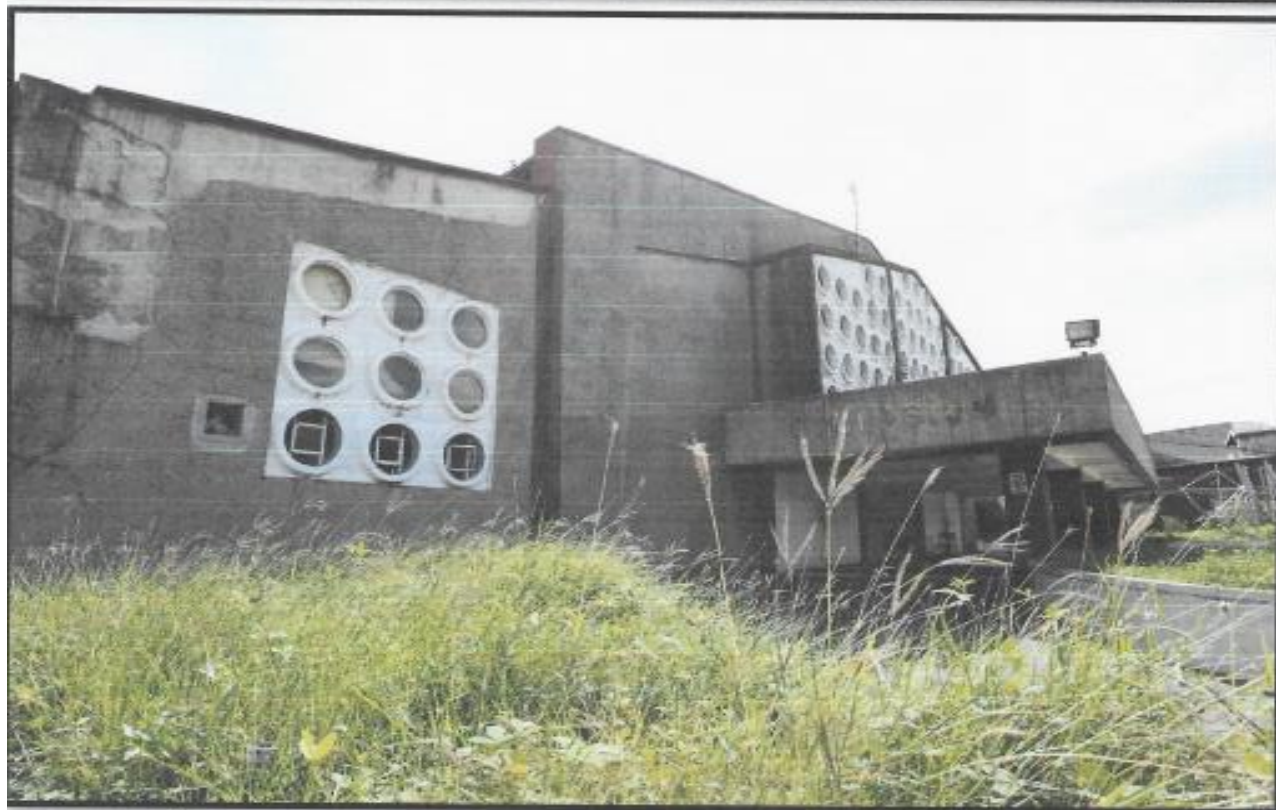

**PUP GYMNASIUM  
(Before)**





POLYTECHNIC UNIVERSITY OF THE PHILIPPINES  
COLLEGE OF ENGINEERING  
**COMPUTER ENGINEERING DEPARTMENT**



**PUP GYMNASIUM  
(Before)**



POLYTECHNIC UNIVERSITY OF THE PHILIPPINES  
COLLEGE OF ENGINEERING  
**COMPUTER ENGINEERING DEPARTMENT**



**PUP GYMNASIUM  
(Before)**





POLYTECHNIC UNIVERSITY OF THE PHILIPPINES  
COLLEGE OF ENGINEERING  
**COMPUTER ENGINEERING DEPARTMENT**



**PUP GYMNASIUM GROUND BREAKING  
CEREMONY**  
**(Under-construction)**



POLYTECHNIC UNIVERSITY OF THE PHILIPPINES  
COLLEGE OF ENGINEERING  
**COMPUTER ENGINEERING DEPARTMENT**

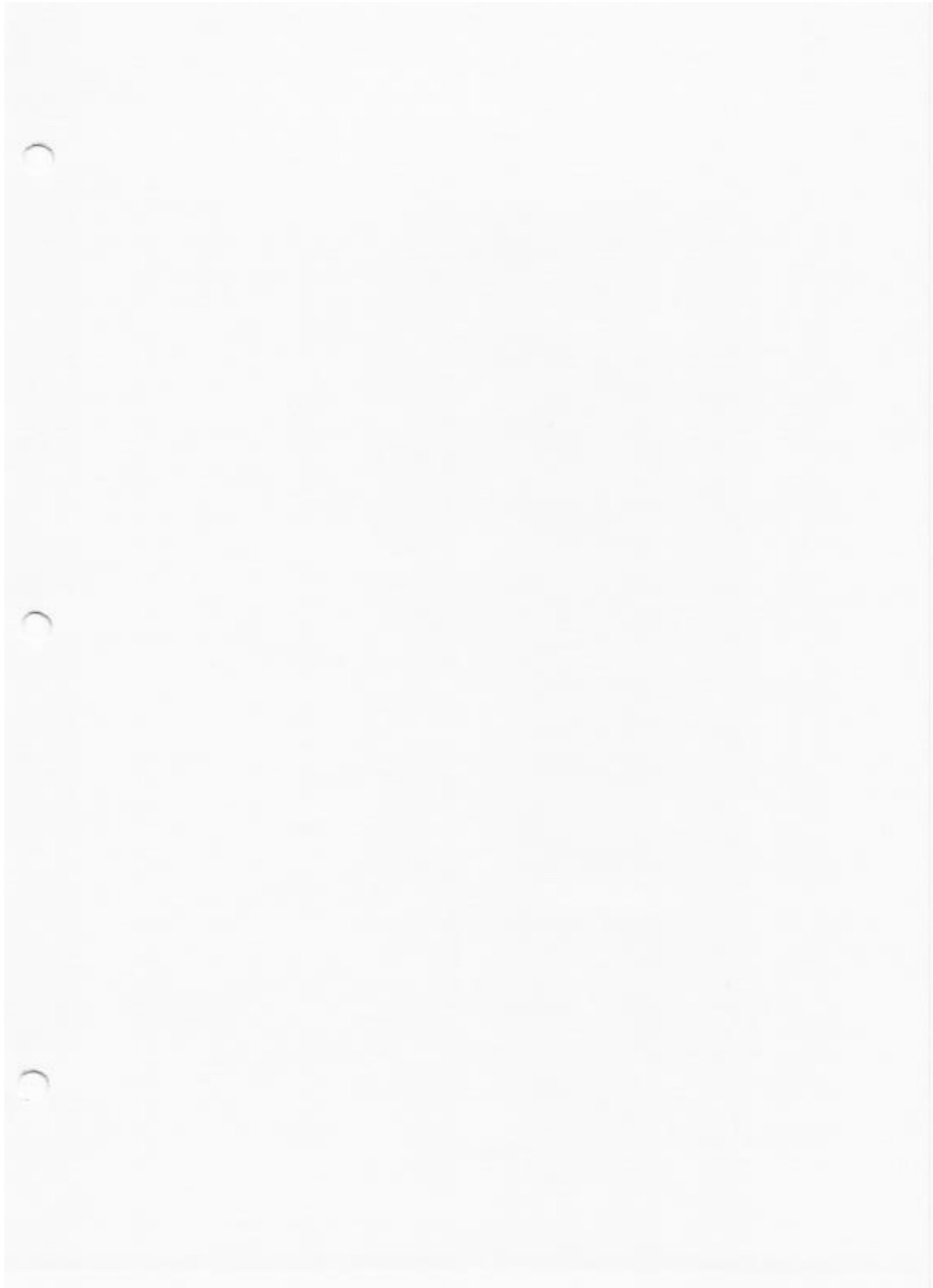





POLYTECHNIC UNIVERSITY OF THE PHILIPPINES  
COLLEGE OF ENGINEERING  
**COMPUTER ENGINEERING DEPARTMENT**

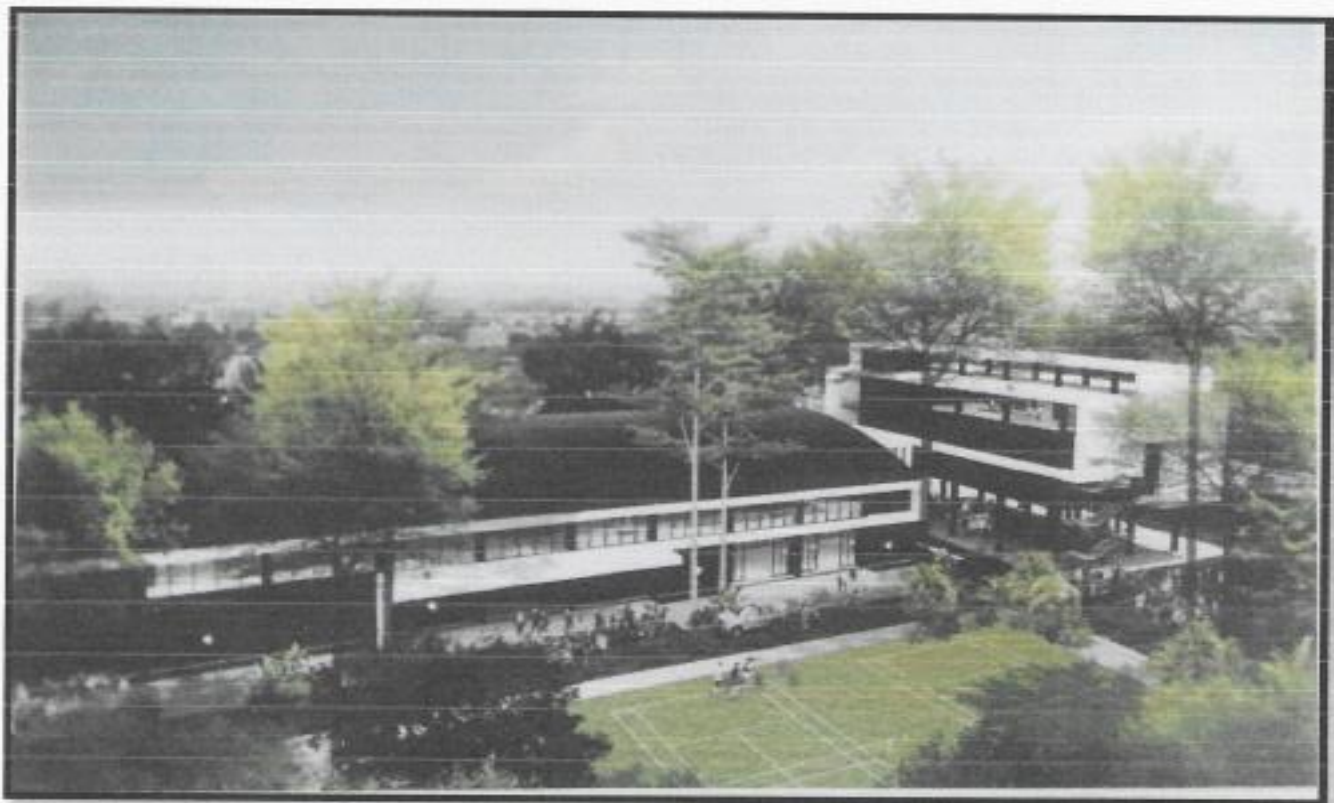

**PUP GYMNASIUM PROPOSED PLAN**  
(Rendered outcome of the gymnasium)



POLYTECHNIC UNIVERSITY OF THE PHILIPPINES  
COLLEGE OF ENGINEERING  
**COMPUTER ENGINEERING DEPARTMENT**

**C. SWIMMING POOL**

• **Laboratory Manual**

**Rules and Regulations**

**Swimming Pool users should:**

1. Present ID to the locker attendant or Swimming Pool Pass before proceeding to the dressing room.
2. Not be suffering from a communicable disease.
3. Always wear bathing suit or trunk (caps included for men and women).
4. Take a shower and use footbath before swimming.
5. Enter the pool only when an instructor or lifeguard is around.
6. Not spit or blow their nose in the pool.
7. Not run around or push others when in the shower or on deck.
8. Not eat in the swimming pool area.
9. Not bring alcoholic drinks in the swimming pool area.
10. Not be on street shoes around the pool area.
11. Get out of the pool in case of lightning and thunderstorm.

• **Operation Manual**

1. The Swimming Pool is open 8:00 am – 12:00 pm and 1:00 pm – 5:00 pm, Monday – Friday.

## **SWIMMING POOL MANUAL**

**(Used to discuss all about the information about laboratory manual on the swimming pool)**





POLYTECHNIC UNIVERSITY OF THE PHILIPPINES  
COLLEGE OF ENGINEERING  
**COMPUTER ENGINEERING DEPARTMENT**

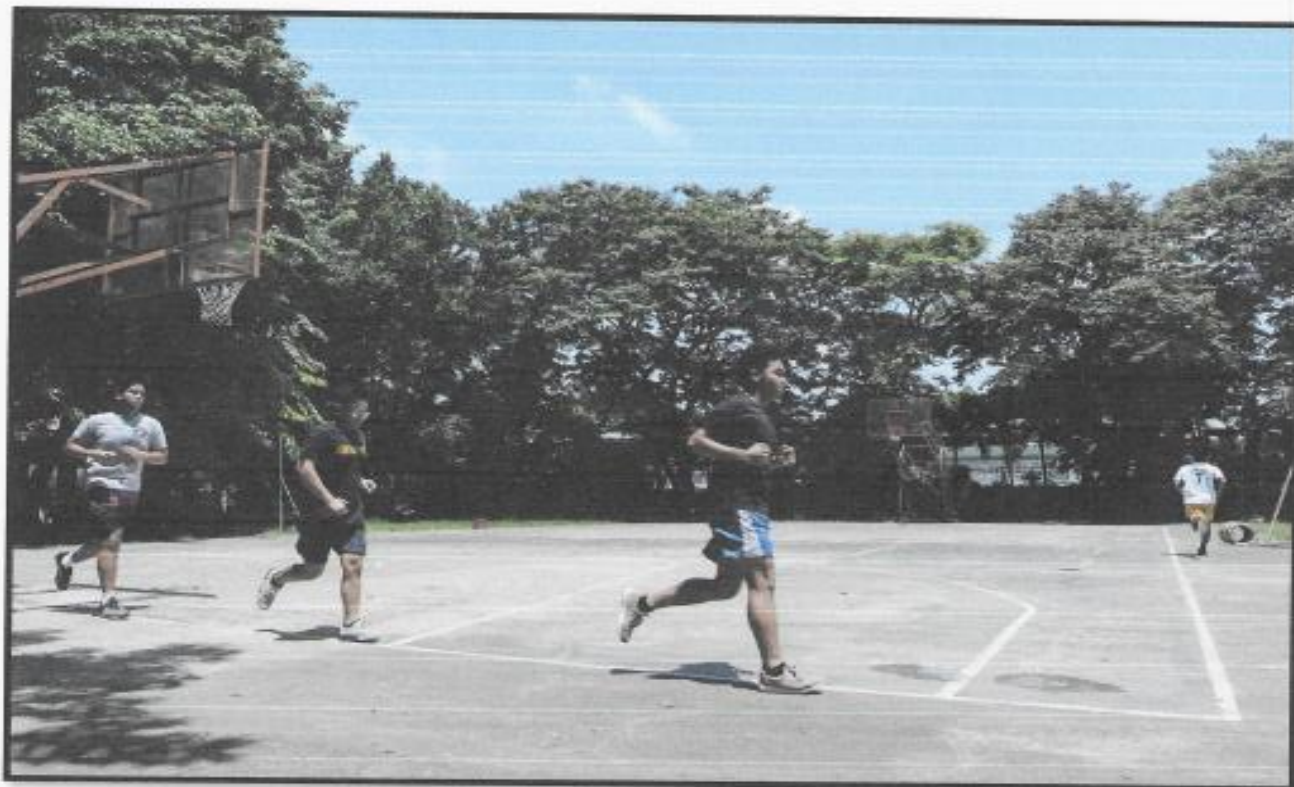

**BASKETBALL COURT**

**(Used for training of basketball player/athletes)**





POLYTECHNIC UNIVERSITY OF THE PHILIPPINES  
COLLEGE OF ENGINEERING  
**COMPUTER ENGINEERING DEPARTMENT**



## **SWIMMING POOL**

**Used for training, swimming lessons and activities)**





POLYTECHNIC UNIVERSITY OF THE PHILIPPINES  
COLLEGE OF ENGINEERING  
**COMPUTER ENGINEERING DEPARTMENT**



## **SWIMMING POOL**

**Used for training, swimming lessons and activities)**





POLYTECHNIC UNIVERSITY OF THE PHILIPPINES  
COLLEGE OF ENGINEERING  
**COMPUTER ENGINEERING DEPARTMENT**



**SWIMMING POOL**

(Used for training, swimming lessons and activities)





POLYTECHNIC UNIVERSITY OF THE PHILIPPINES  
COLLEGE OF ENGINEERING  
**COMPUTER ENGINEERING DEPARTMENT**

**E. BASKETBALL COURT (OUTDOOR)**

• **Laboratory Manual**

1. Students should wear the proper uniform and rubber shoes in the Basketball court.
2. Only students with scheduled Physical education classes can use the Open Basketball court. Spectators/observers who wish to enter have to ask the permission of the Physical Education teacher/instructor in charge.
3. All equipment used must be properly accounted for and returned to the utility room for safekeeping.
4. For varsity practices, the team can use the court only during scheduled practices.
5. Presence of the trainer/coach of the varsity team is a requirement during practices.
6. It is the coach's/trainer's/advisor's responsibility to observe the proper use of the area.
7. Maintain cleanliness at times.

• **Operation Manual**

1. The Basketball Court is open 8:00 am – 12:00 pm and 1:00 pm – 6:00 pm, Monday – Saturday.
2. Activities requiring the use of this service facility for more than five (5) days (except sports) shall not be allowed.

**BASKETBALL COURT MANUAL**

**(Used to discuss all about the information about laboratory and operation manual on the basketball court)**



POLYTECHNIC UNIVERSITY OF THE PHILIPPINES  
COLLEGE OF ENGINEERING  
**COMPUTER ENGINEERING DEPARTMENT**



**BASKETBALL COURT**

(Used for training of basketball player/athletes)





POLYTECHNIC UNIVERSITY OF THE PHILIPPINES  
COLLEGE OF ENGINEERING  
**COMPUTER ENGINEERING DEPARTMENT**

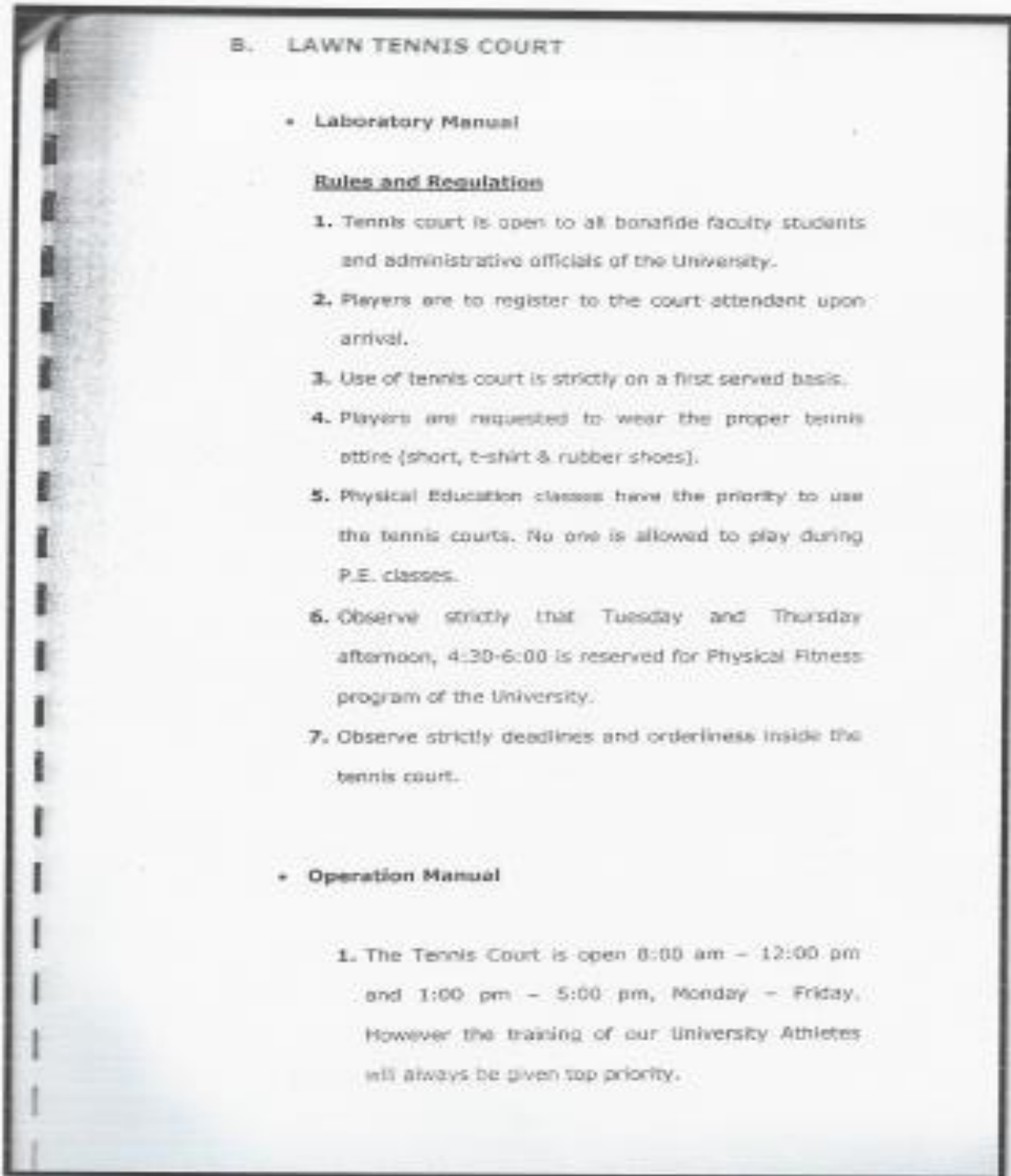

**LAWN TENNIS MANUAL**  
**(Used to discuss all about the information about laboratory and operation manual on the Lawn tennis)**



POLYTECHNIC UNIVERSITY OF THE PHILIPPINES  
COLLEGE OF ENGINEERING  
**COMPUTER ENGINEERING DEPARTMENT**



## LAWN TENNIS

(Used for training of tennis player/athletes)





POLYTECHNIC UNIVERSITY OF THE PHILIPPINES  
COLLEGE OF ENGINEERING  
**COMPUTER ENGINEERING DEPARTMENT**



**OPEN COURT (VOLLEYBALL/BADMINTON)**  
**(Used for training of volleyball/ badminton player/athletes)**



POLYTECHNIC UNIVERSITY OF THE PHILIPPINES  
COLLEGE OF ENGINEERING  
**COMPUTER ENGINEERING DEPARTMENT**



**NEMESIO  
PRUDENTE  
PARK, FLAG  
POLE,,  
OBELISK AND  
MABINI  
MONUMENT**





POLYTECHNIC UNIVERSITY OF THE PHILIPPINES  
COLLEGE OF ENGINEERING  
**COMPUTER ENGINEERING DEPARTMENT**

